

GSH Identification Solutions B.V.
E-mail: info@gsh-id.nl
www.gsh-id.nl
Tel. 0184 421 859



CREATE

PRINT

INTEGRATE

AUTOMATE

For label printing automation

Do you wish your ERP system would also print your product, parts, pallet, and shipping labels? SENTINEL can make that happen. By capturing data from your existing system, SENTINEL can automatically determine the label format, what data should print, and what printer to use. SENTINEL is low maintenance and efficient, saving you time by eliminating unnecessary processes and the need for manual support.

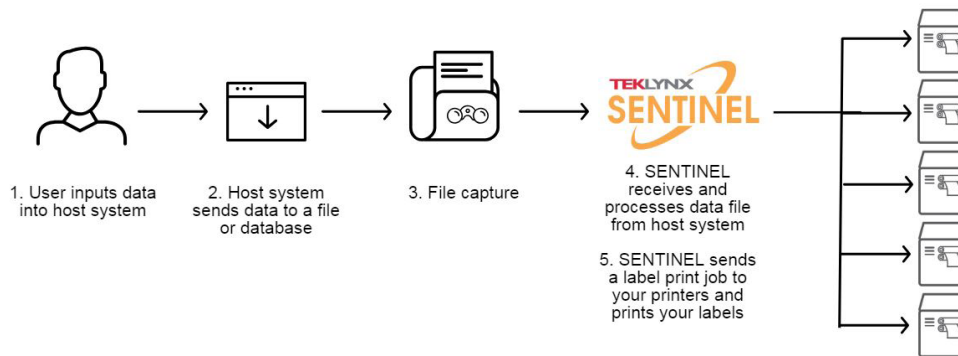

SENTINEL automates printing for your entire organization

Print users continue to work with a system they already know, which decreases the amount of training each print user needs. The flow of data is as easy to follow as 1-2-3:

1.

When the print user initiates a print request, the host system sends a data file to a network folder.

2.

When the data file is created, a Windows event triggers SENTINEL to process the data file.

3.

SENTINEL determines the label, data, and printer from the information sent from the host system and prints the label.

Benefits of SENTINEL

- **Flexible** - Integrates with multiple systems and prints to multiple printers across your enterprise environment.
- **Scalable** - SENTINEL can grow with your business by enabling you to quickly and easily add printers to your existing network.
- **Accurate** - Combined with CODESOFT, you will get precise WYSIWYG results from screen label design to printed label.
- **Remote Administration** - System configuration setup, management, and editing can be accessed remotely through an Internet connection.
- **Multi-Threaded** - SENTINEL sends labels to multiple printers on your network at one time.
- **Customizable** - Set priority levels for your print requests according to your business needs.
- **Reliable** - SENTINEL manages duplication of all configuration data, ensuring that you have a secondary server to rely on during upgrades or scheduled maintenance.

www.teklynx.com/sentinel



Is SENTINEL your solution?

Save time and prevent errors by eliminating unnecessary manual processes. Clicking "print" from your ERP, WMS, or business system drops a file into a SENTINEL watch folder. SENTINEL reads the file and automatically executes an accurate print job!

Our users integrate SENTINEL with ERP systems like SAP, Oracle, and Global Shop Solutions to seamlessly pull in accurate data to their labels. SENTINEL leverages CODESOFT printer drivers to support accurate and fast printing to over 3,000 printers.

Companies who use SENTINEL typically have:

- Over 10 printers
- Significant number of users
- Multiple production lines and locations
- Lean manufacturing initiatives
- Compliance regulations
- Business system integration

Request a **FREE** consultation for **SENTINEL** at:

www.teklynx.com/sentinel

About TEKLYNX

TEKLYNX International helps supply chains work better. Today, more than 750,000 companies in over 170 countries trust TEKLYNX integrated barcode and RFID label design products and the people behind its solutions to make barcode labeling operations efficient, accurate, secure and industry compliant. With over 30 years of experience, TEKLYNX is the global leader because of its reliable software and superior customer support. To learn more about how the TEKLYNX community helps companies across industries worldwide, visit teklynx.com or call TEKLYNX in your region. Barcode Better™ with TEKLYNX.

Connect With Us



Contact Us

United States +1 (414) 837-4800	France +33 (0) 562 601 080
Germany +49 (0) 2103 2526 0	Singapore +65 6908 0960

TEKLYNX offers solutions for all levels of labeling complexity

LABEL MATRIX

- Simple labeling requirements with fixed data
- Familiar interface
- Helpful label design wizards



LABELVIEW

- Mid-level labeling requirements
- Simple database connections
- Customizable print forms
- Intuitive interface



CODESOFT

- Complex labeling requirements
- RFID support
- Complex database integration
- Regulatory compliance, such as:
 - Unique Device Identification (UDI)
 - Globally Harmonized System of Classification and Labeling of Chemicals (GHS)



Enterprise Label Management Solutions

- Maximum complexity labeling requirements
- CODESOFT + SENTINEL integrates with any ERP system to completely automate label printing
- CODESOFT + LABEL ARCHIVE enables tracking of every aspect of the label design process, robust user permissions, and version control
- TEKLYNX CENTRAL is an all-in-one, centralized, browser-based label management solution for the whole enterprise



Uw distributeur

GSH Identification Solutions B.V.
Lelystraat 93K
3364 AH Sliedrecht
Tel. +31 (0) 184 421 859
www.gsh-id.nl
info@gsh-id.nl